



299 BROADWAY

P&Z #22-092

COMPREHENSIVE PERMIT APPLICATION
LOT 04

NOVEMBER 8, 2022

COMPREHENSIVE PERMIT APPLICATION DRAWING LIST

| | |
|---------|------------------|
| A000.41 | COVER SHEET |
| A000.42 | SCALED SITE PLAN |

LOCUS MAP





299 BROADWAY

P&Z #22-092

COMPREHENSIVE PERMIT APPLICATION
LOT 04

NOVEMBER 8, 2022

COMPREHENSIVE PERMIT APPLICATION DRAWING LIST

| | |
|---------|--------------------|
| A000.D1 | COVER SHEET |
| A000.D2 | SCALED SITE PLAN |
| A000.D3 | DIMENSIONAL TABLES |

LOCUS MAP



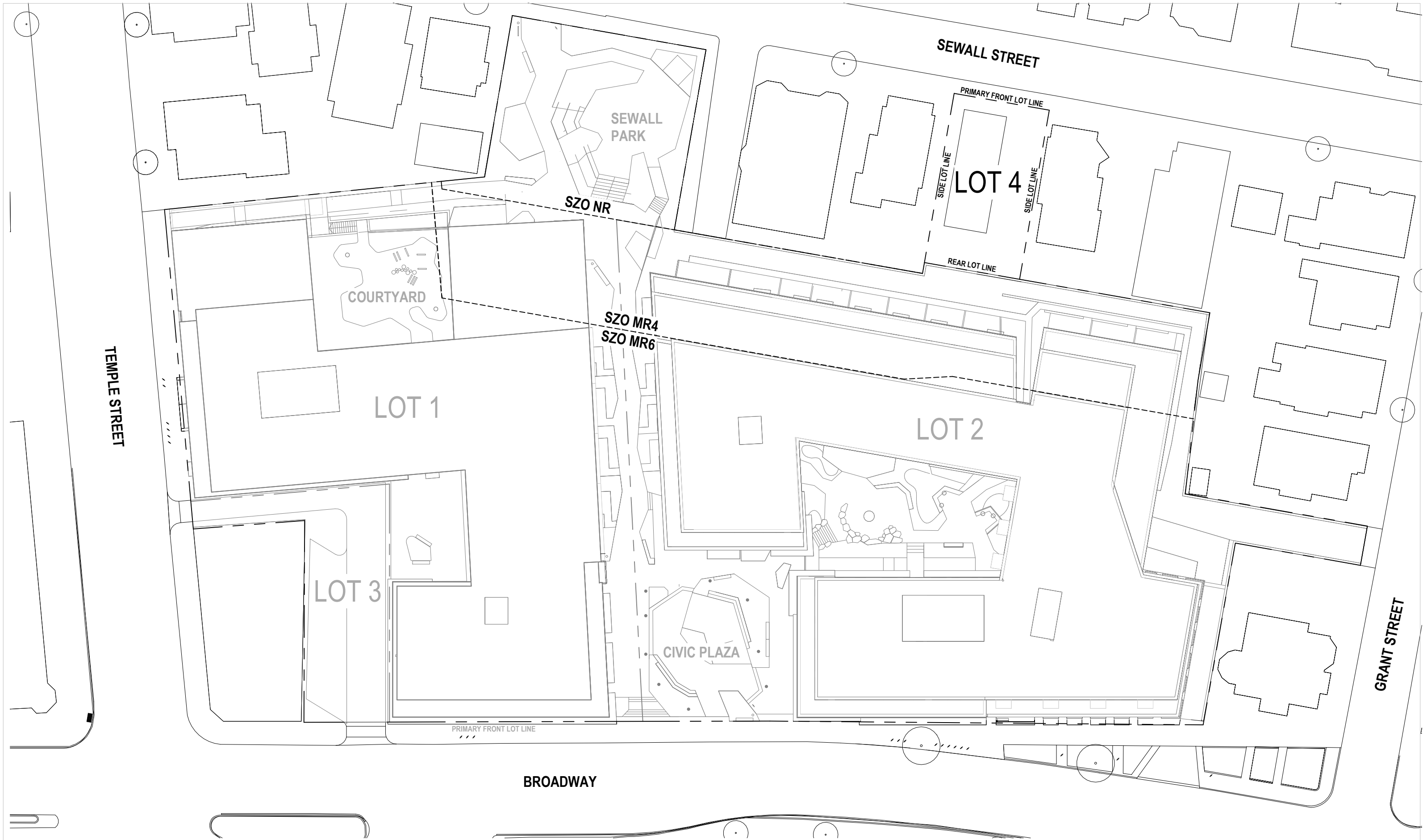

| LOT 4 ZONING AND DEVELOPMENT SUMMARY | | | |
|--------------------------------------|---------------------------------|-----------|---|
| ZONING DISTRICT | NR | | |
| TRANSIT AREA | YES - INSIDE HALF MILE WALKSHED | | |
| PEDESTRIAN STREET | NO | | |
| PRINCIPAL BUILDING TYPE | NO BUILDING PROPOSED | | |
| LOT AREA (SQFT) | <u>WHOLE LOT</u> | <u>NR</u> | — |
| | 3,601 | 3,601 | |
| GROSS FLOOR AREA (SQFT) | 0 | 0 | |
| RETAIL/COMMERCIAL | 0 | 0 | |
| RESIDENTIAL | 0 | 0 | |
| MECHANICAL | 0 | 0 | |

| ZONING TABLES | | | |
|------------------------------|---------------------|-------------------|------------------|
| | ALLOWED NR | PROPOSED NR | AS OF RIGHT |
| LOT DIMENSIONS & DEVELOPMENT | | | |
| LOT WIDTH (MIN) | | | |
| NO DRIVEWAY ACCESS | VARIES ³ | 45FT ² | YES ³ |
| LOT DEPTH (MIN) | VARIES ³ | 80FT | YES |
| LOT COVERAGE (MAX) | 60% | 0% | YES |
| GREEN SCORE | | | |
| MIN/IDEAL | .35/.40 | 0 ¹ | NO ¹ |

| NOTES |
|---|
| 1. PLEASE REFER TO ATTACHED REQUESTED WAIVERS MASTER LIST 2. MINIMUM LOT WIDTH REQUIREMENT DETERMINED BY ACCESS: NO DRIVEWAY ACCESS - 32FT, SIDE OR REAR DRIVEWAY ACCESS - 32 FT, FRONT DRIVEWAY ACCESS - 34FT. NO DRIVEWAY ACCESS HAS BEEN ASSUMED IN THIS ZONING SUMMARY ASSESSMENT. 3. DIMENSIONAL REQUIREMENTS IN NR DISTRICTS ARE DEPENDANT ON THE TYPE OF BUILDING PROPOSED. PROJECT IS NOT PROPOSING A BUILDING FOR LOT 4. |

